

# MudMaster™

WASHES, CONTAINS, AND RECYCLES

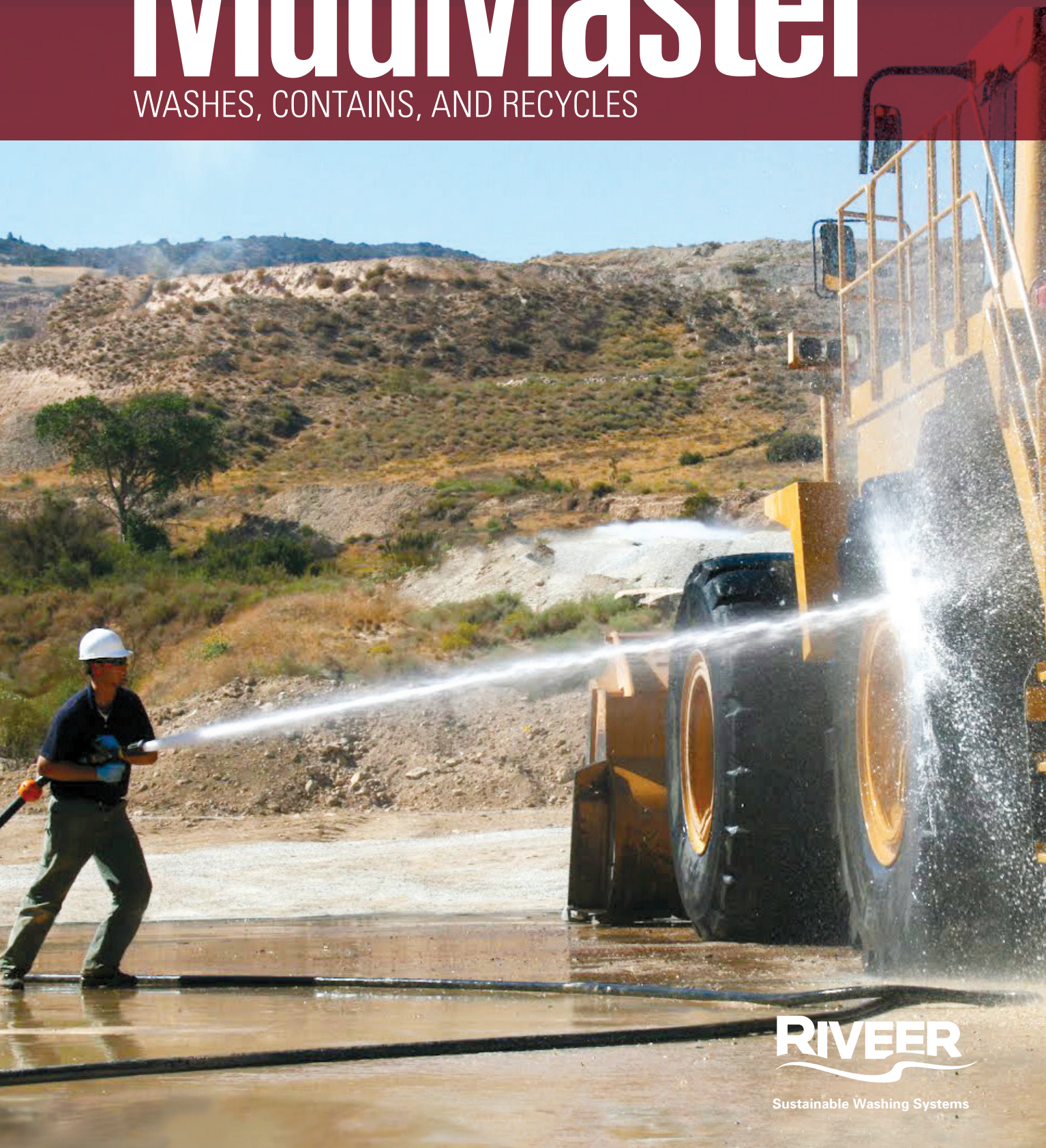

**RIVEER™**

Sustainable Washing Systems

The Solution is Clear with Riveer™



# MudMaster™

## Environmentally Compliant Wash and Recycling System

- BLAST OFF MUD AND OIL WITH WATER CANNONS AND HOT WATER PRESSURE WASHERS
- ABOVE-GROUND OR IN-GROUND WASH RACKS DESIGNED TO MEET YOUR REQUIREMENTS
- GRIPSTART™ ON/OFF
- COMPLETE PLUG AND PLAY PACKAGE
- SYSTEM OF CHOICE THROUGHOUT THE WORLD

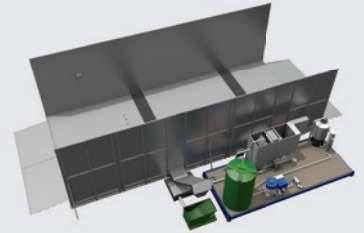

MudMaster™ meets all US and CE electric standards: UL, TUV, IEC, NEC, NFPA.

### MUDMASTER™ EQUIPMENT WASHING SYSTEMS GET IT CLEAN FAST...AND GET COMPLIANT NOW

From the sun-baked deserts of the Middle East to the oil and gas fields of the U.S. the Riveer MudMaster™ has met the demanding challenge of washing military vehicles, fracking rigs, construction equipment, waste haulers and other hardworking rigs. Mud, muck, dust and dirt are no match for Mudmaster's water cannons, solids separation technology and filtration. Where the payloads are heavy and the roads are long, you'll find MudMaster right at home.

Every MudMaster features Riveer's GripStart™ on/off system, making it easy for driver, operator or soldier to get his equipment washed quickly and easily.

Riveer wash lanes are 18' wide with 6' high over spray walls. The non-skid flat (not undulating) surface provides the users with a safe and comfortable deck to work on. The low deck height, 6" is significantly lower than any other wash rack and makes for safe low angle drive on ramps. The wash pads can be any length and can be equipped with automatic mud conveyors to ease cleanup.



# MudMaster™ 1000

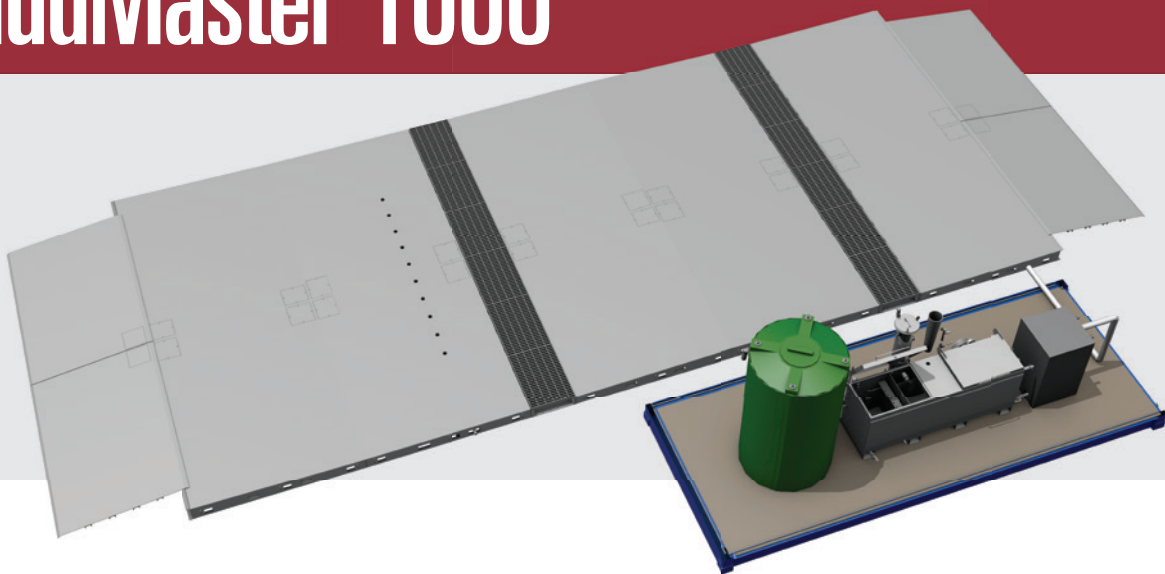

## MUDMASTER™ 1000

The MudMaster 1000 was designed to deal with light to moderate dirt loads. This closed loop washing and filtration system is ideal for equipment washing, including forklifts, light duty trucks, booms and scissor lifts, etc. The MudMaster 1000 employs the RTS 1000 water treatment system, perfect for light dirt loads. The zero discharge process allows environmentally safe cleaning by using a simple filtration process and features a built in oil-water separator. The unit comes with a regenerative blower to suck up wash water from Riveer above ground racks, or from a surface mat or other shallow collection point. Not only is MudMaster used for parts washing and equipment degreasing, it is also used in acid washing applications. The MudMaster 1000 will keep your maintenance area clean while assuring you of no chemical discharge or polluted wash water.



Helps meet SWPPP  
and other pollution  
prevention regulations



One button GripStart operation:

- Squeeze pressure washer gun and system starts
- Release gun and walk away
- System automatically cycles and shuts down

## FAST TO SETUP, EASY TO OPERATE, SIMPLE TO MAINTAIN

- Stainless steel
- 250-gallons of mud settling
- NEMA 4 electrics
- PLC controlled
- Continuous ozone injection
- Oil coalescing
- Automatic oil skimmer
- Absolute filtration to 5 microns
- 24/7 continuous recirculation

# MudMaster™ 3000



## MUDMASTER™ 3000

The MudMaster 3000 handles moderate to heavy mud loads, and consequently is used for equipment washing on job sites and maintenance areas. MudMaster is an ideal solution for deployable applications where vehicle track out is a concern. The MudMaster 3000 employs the RTS 3000 water treatment system to add the extra automation that higher dirt loads demand.

The stainless steel filtration system features inclined plate separators to settle mud in a large initial settling chamber. The chamber is sloped to a valve that automatically purges settled solids every night. Oil coalescing in conjunction with ozone or bacteria injection completes the initial stage. Wash water is recovered with a run dry diaphragm pump. High-pressure industrial media filtration removes suspended solids, heavy metals, VOC's and microbes, which is automatically back-washed every night. A final absolute polishing filter cleans the water before sending it to a holding tank. Like all Riveer Environmental systems, all water in the system is continuously circulated and injected with ozone.



## APPLICATIONS

Designed for moderate mud loads found in washing:

- Industrial and commercial maintenance facilities
- Permanent and field military installations for washing, decontamination and corrosion control
- Equipment washing where wash water includes mud, clay, debris and oils
- Municipal road depots, including salt trucks and street sweepers

## FEATURES

- One button GripStart operation:
  - Squeeze pressure washer gun and system starts
  - Release gun and walk away
  - System automatically cycles and shuts down.
- Stainless steel
- Completely automatic system
- Continuous ozone injection
- Oil coalescing
- High-pressure industrial media filtration
- 500-gallons of mud settling
- PLC controlled
- Automatic oil skimmer
- Absolute filtration to 5 microns
- Continuous recirculation





# MudMaster™ 5000



## MUDMASTER™ 5000

MudMaster 5000 starts with high-flow and high-pressure water cannons. As the water cannons blasts the muck off the vehicle, the solids stream is channeled to the automatic drag conveyors built into the wash pad. No other company offers this unique (patent pending) system that incorporates wedge wire screen filtration before the wash water enters the filtration system.

The MudMaster 5000 incorporates the Riveer RTS 5000 water treatment system that starts with a 850-gallon settling chamber with built-in mud conveyor to remove settled solids in real time. This system handles huge amounts of dirt and mud due to unequaled designed dwell time and a built in conveyor.

Riveer knows that handling mud is the hardest task for any wash rack and that is why only Riveer wash racks are equipped with automatic conveyors to drag the mud to hoppers, both from the rack and the stainless steel filtration system. Once in the hopper, the mud can be easily disposed of with a forklift. No other company has anything like this. Thanks to robust industrial filtration technology; MudMaster is ready to run for years in the toughest applications.



## APPLICATIONS

Equipment washing where wash water includes mud, clay, debris and oils

- Permanent and field military installations for washing, decontamination and corrosion control
- Fracking and other oil field operations
- Construction equipment
- Large rental yards
- Industrial and commercial maintenance facilities
- Municipal road depots, including salt trucks and street sweepers
- Rental businesses

## FEATURES

- Only filtration system with built-in mud conveyor
- One button GripStart operation:
  - Squeeze pressure washer gun and system starts
  - Release gun and walk away
  - System automatically cycles and shuts down
- Stainless steel
- Completely automatic system
- Continuous ozone injection
- Oil coalescing
- High-pressure industrial media filtration
- 850-gallons of mud settling
- PLC controlled
- Automatic oil skimmer
- Absolute filtration to 5 microns
- Continuous recirculation
- ¼ yard self dumping hopper



# MudMaster™ Washes, Contains, and Recycles

## MUDMASTER™ 1000 SPECIFICATIONS

**Capacity:** 250 gallons plus holding tank  
**Weight:** 1200 lbs.  
**Dimensions:** 102" L x 48" W x 50" H  
**Electric:** 208, 240, 480 single or three phase  
**Process Rate:** 0-40 GPM  
**PSI:** 80-15,000  
**GPM:** 4-80  
**Material:** 304 stainless steel

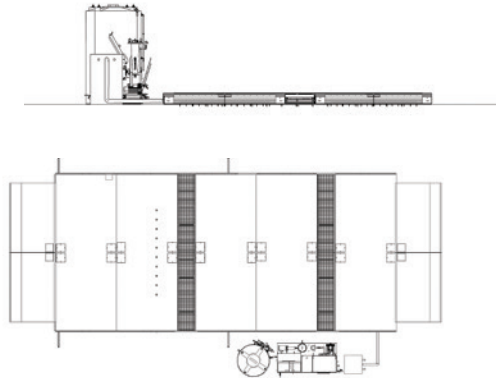

## MUDMASTER™ 3000 SPECIFICATIONS

**Capacity:** 500 gallons plus holding tank  
**Weight:** 1700 lbs.  
**Dimensions:** 48' W x 96' L x 55' H  
**Electric:** 220V Single or 240, 480 Three-phase  
**Process Rate:** 12-50 GPM  
**PSI:** 80-15,000  
**GPM:** 4-80  
**Material:** 304 stainless steel

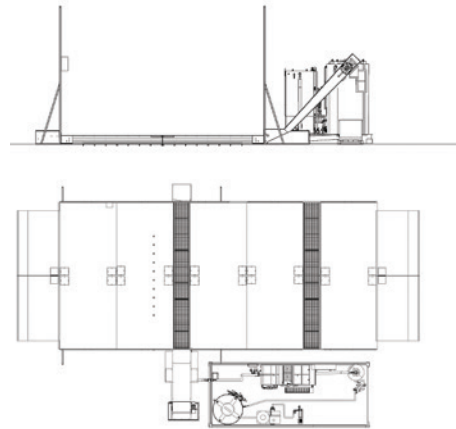

## MUDMASTER™ 5000 SPECIFICATIONS

**Capacity:** 850 gallons plus holding tank  
**Weight:** 3200 lbs.  
**Dimensions:** 112" L x 76" W x 82" H  
**Electric:** 208, 240, 480 single or three phase  
**Process Rate:** 0-25 GPM  
**PSI:** 80-15,000  
**GPM:** 4-80  
**Material:** 304 stainless steel

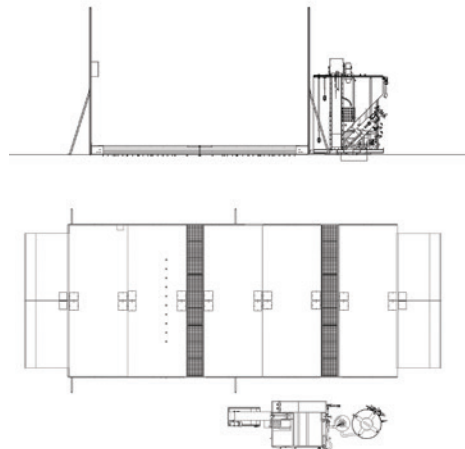

Riveer Environmental employs a quality management system that is ISO 9001:2008 certified.  
©2012 RIVEER Sustainable Washing Systems. All rights reserved. Specifications subject to change. R8.12

